

File name \\UK\WSPGROUP\IP\CENTRAL\DATA\PROJECTS\70059810 - LTP DESIGN & MANAGEMENT\19-20\PACKAGE 2\108 - CLEOBURY MORTIMER\03 DRAWINGS\PHASE 2\WIP\70059810-WSP-GEN-A417-DR-CH-0101-EXTENDED.TRO KH.DWG, printed on 19 January 2021 09:05:19, by Hatton, Kfi

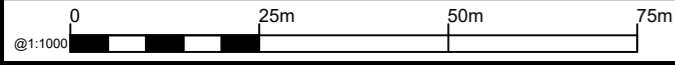
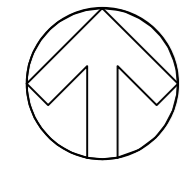
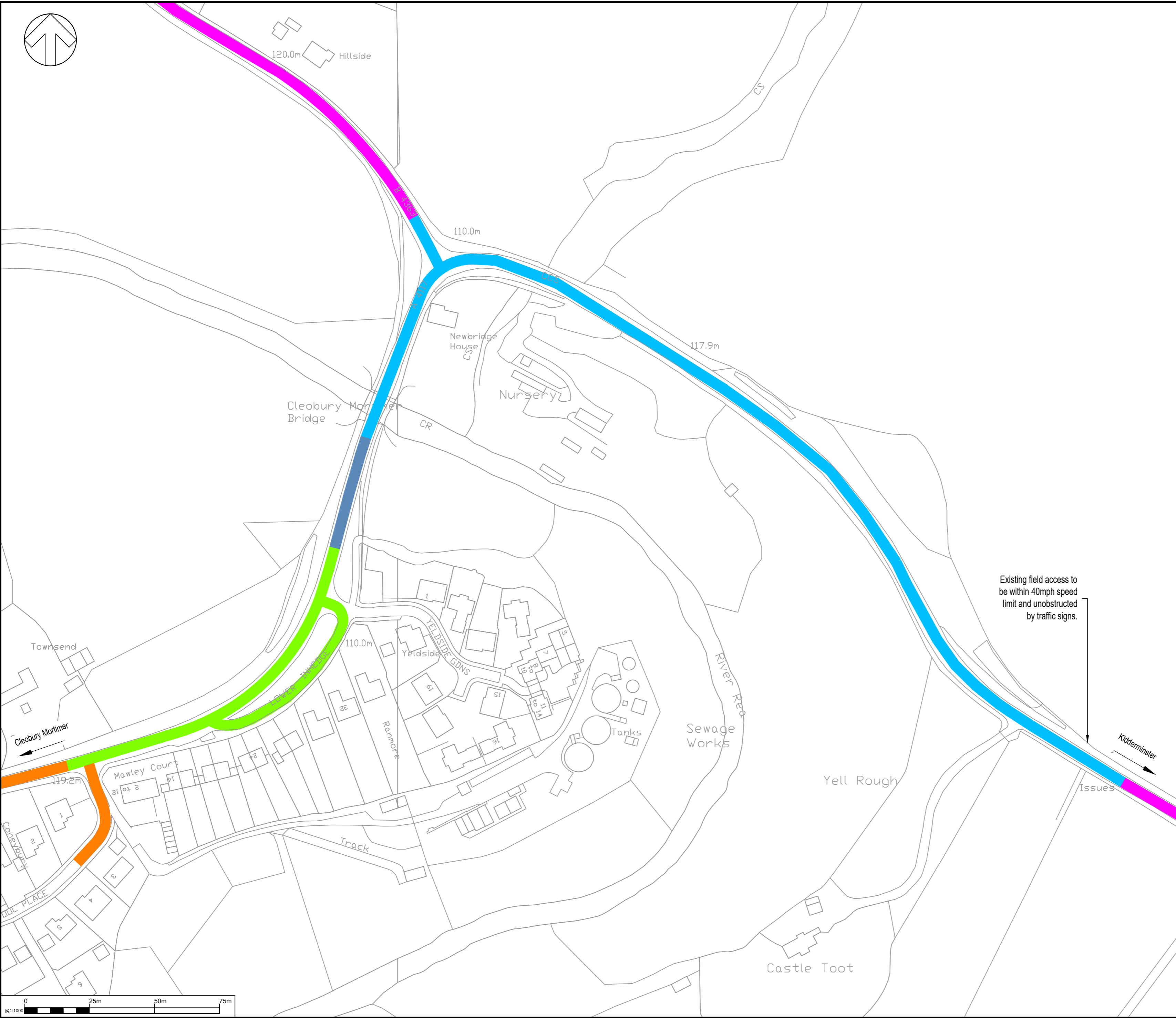

**DO NOT SCALE**

© Crown copyright and database rights 2020 OS 100049049. You are permitted to use this data solely to enable you to respond to, or interact with, the organisation that provided you with the data. You are not permitted to copy, sub-licence, distribute or sell any of this data to third parties in any form.

**Key**

<span style="color: orange;">█</span>	Existing 30mph speed limit
<span style="color: lime;">█</span>	Existing 40mph, Proposed 30mph speed limit
<span style="color: blue;">█</span>	Existing 40mph speed limit
<span style="color: lightblue;">█</span>	Existing national speed limit, proposed 40 mph speed limit
<span style="color: magenta;">█</span>	Existing national speed limit

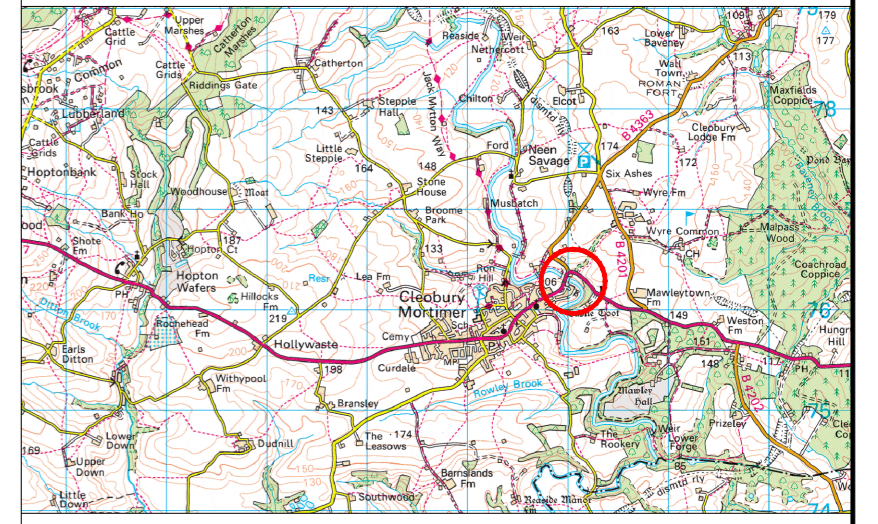

REV	DATE	BY	DESCRIPTION	CHK	APP
P02	18/01/2021	AP	EXTENTS OF SPEED LIMITS REVISED	KH	DD
P01	24/07/2020	PD	FIRST ISSUE	KH	DD

DRAWING STATUS: **S2 - FOR INFORMATION**



2nd Floor Shirehall, Abbey Foregate, Shrewsbury, SY2 6ND, UK  
T+ 44 (0) 1743 501 060  
wsp.com

CLIENT:



PROJECT: **A4117 PROPOSED SAFETY MEASURES CLEOBURY MORTIMER**

TITLE: **Proposed 30mph and 40 mph speed limit extension Consultation Plan.**

SCALE @ A2: 1:1250	CHECKED: K. Hatton	APPROVED: D. Davies
PROJECT No: 70059810	DESIGNED: P. Davey	DRAWN: P. Davey
DRAWING No: 70059810-WSP-GEN-A4117-DR-CH-0101	DATE: July 2020	REV: P02

© WSP UK Ltd

Existing field access to be within 40mph speed limit and unobstructed by traffic signs.