

Sign type CS3 next to bay

Listley Street and St. Mary's Street Proposed Residents Parking Scheme Consultation

**Residents parking only
24 hours / 7 days a week in
existing and new bays as well
as a shared loading bay**

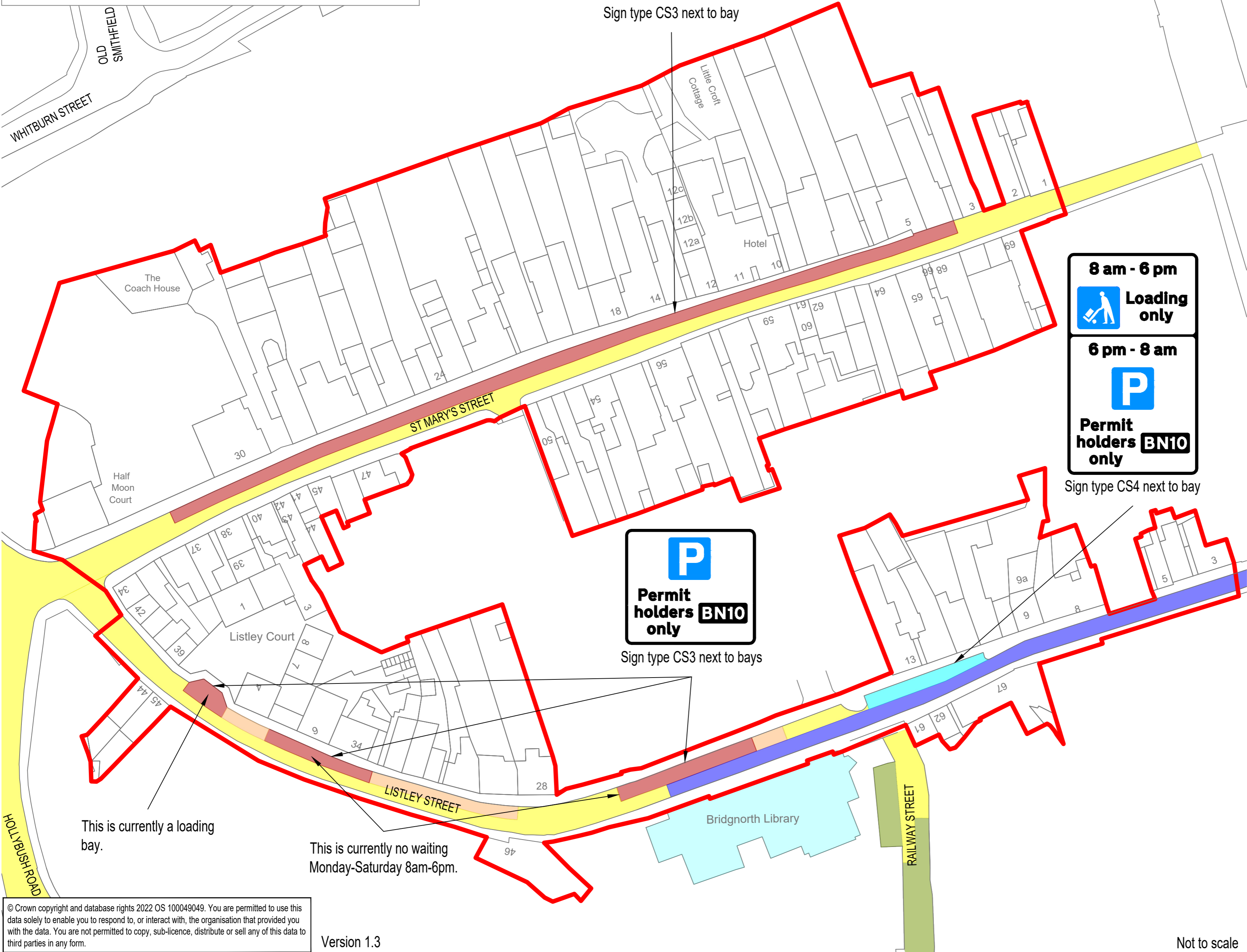

8 am - 6 pm
Loading only
6 pm - 8 am
Permit holders only

Sign type CS4 next to bay

Permit holders only

Sign type CS3 next to bays

KEY:

- Identified residential properties within area proposed to be included in Listley Street and St. Mary's Street Area scheme.
- Existing: Loading bay or no waiting Monday-Saturday 8am-6pm.
Proposed: 24 hours / 7 days a week BN10 residents permit holders only.
- Existing: Loading bay.
Proposed: Loading bay 8am-6pm. BN10 residents permit holders only 6pm-8am.
- Existing: No waiting Monday-Saturday 8am-6pm.
Proposed: No waiting at any time (double yellow lines).
- Existing no waiting at any time (double yellow lines) to remain.
- Existing no waiting & no loading at any time to remain.
- Parking in this area is for Railway Street BN2 residents only.

This is currently a loading bay.

This is currently no waiting Monday-Saturday 8am-6pm.

© Crown copyright and database rights 2022 OS 100049049. You are permitted to use this data solely to enable you to respond to, or interact with, the organisation that provided you with the data. You are not permitted to copy, sub-licence, distribute or sell any of this data to third parties in any form.